

Basic Troubleshooting

*LED not displayed

Check that your power supply is correct voltage (DC5V) and correct polarity.

Check the connection of signals cable

*Display appears scrambled

Check that all connections are correct and tight.

Check that there is no harsh interference nearby.

*0000 Displayed

Voltage or current out of range. (protect mode)

*Others:

The reading is not "0" when the input signal was shorted. The A/D chip was by breakdown sometimes

*Caution

Do not disassemble

The polarity of power source prohibit reversed.

*Panel Cutout Size

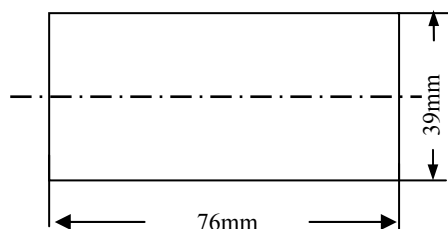

XL5145A (DC/DC)Series Digital Ammeter Power supply DC5V measuring DC ampere

FEATURES:

Power supply DC5V

Ultra-bright LED display

15.00mm digital height

Blue/Red/Green displays available

Measured DC polarity: Automatic

Auto zero reading for 0v/a input.

Low cost high accuracy

Can be re-calibrated by adjusting the calibration potentiometer

Easy to install

The location of the decimal point can be adjusted

OPERATION SPECIFICATIONS:

Power Supply	DC5V±10%
Power Consumption	150mA±2%
Maximum Count	19999
Operating temperature	0℃~60℃
Storage Temperature	-20℃~80℃
Relative humidity	20%~80%
Over Range Indication	0000 flash
Dimension	W79mm x H42.5mm x D25.5mm
Panel Cutout	76mm×39mm
Sample Frequency	400ms

MANUAL

DIGITAL Ammeter

XIELI

Shaanxi XIELI Photo Electric Instrument Co., Ltd

Add: No.2 Xinke Rd, Eastern Development Zone,

Xi'an 710043, Shaanxi, CHINA

Tel: +86-29-82622375 Fax:+86-29-84023638

Email: info@xieli-china.com

<http://www.xieli-china.com>

CONNECTION DIAGRAM:

View of PINs with screen facing upwards.

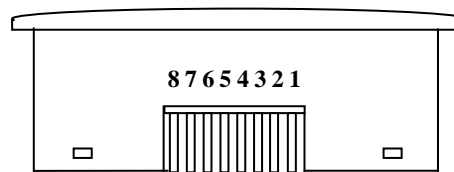

PIN 1 DC + ampere signal input

PIN 2 DC - ampere signal input

PIN 3 DC5V- Power supply

PIN 4 Data Hold [Short connection PIN3 & PIN4]

*The data hold control cable must be less than 30cm.

PIN 5 Decimal position 19.999[Short connection PIN3 & PIN5]

PIN 6 Decimal position 199.99[Short connection PIN3 & PIN5]

PIN 7 Decimal position 1999.9[Short connection PIN3 & PIN7]

PIN 8 DC5V+ Power supply

Model	Range	Resolution	Input Impedance	Max Ampere Input	Accuracy
XL5145A-1	±199.99uA	0.01uA	1KΩ	±2mA	±0.1%+2digit
XL5145A-2	±1.9999mA	0.1uA	100Ω	±20mA	±0.1%+2digit
XL5145A-3	±19.999mA	1uA	10Ω	±100mA	±0.1%+2digit
XL5145A-4	±199.99mA	10uA	1Ω	±500mA	±0.1%+2digit