

Basic Troubleshooting

LED not displayed

Check the power source is correct voltage (DC5V) and correct polarity.

Keep the connection of signals cable is tight.

Display appears scrambled

Check that all connections are correct and tight.

Check that there is no harsh interference nearby.

1 or -1 Displayed

Voltage or Current over its measuring range. (Protect mode)

Others:

The reading is not "0" when the signal terminals was shorted, the A/D chip was by breakdown sometimes

Panel Cutout Size

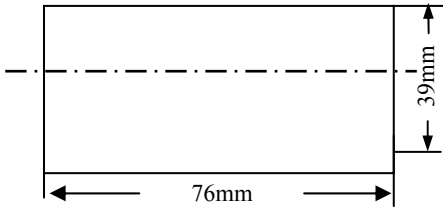

MANUAL
DIGITAL PANEL METER

XIELI

ISO9001-2008 & CE

Basic Troubleshooting

LED not displayed

Check the power source is correct voltage (DC5V) and correct polarity.

Keep the connection of signals cable is tight.

Display appears scrambled

Check that all connections are correct and tight.

Check that there is no harsh interference nearby.

1 or -1 Displayed

Voltage or Current over its measuring range. (Protect mode)

Others:

The reading is not "0" when the signal terminals was shorted, the A/D chip was by breakdown sometimes

Panel Cutout Size

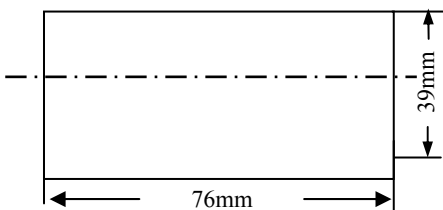

MANUAL
DIGITAL PANEL METER

XIELI

ISO9001-2008 & CE

XL41LCD Series DC voltmeter

Power Source DC5V

FEATURES:

- Power supply DC5V
- LCD display with Blue backlighting
- 15.00mm digit height
- Low cost
- High accuracy
- Decimal point is settable by user
- Easy to install, snap-in/mount in panel
- Ideal for auto, boat, industrial, commercial & domestic uses

OPERATION SPECIFICATIONS:

Power Source	DC5V±0.2V (2 mA)
Maximum Count	19999 (4.5 digits)
Accuracy	±0.05%+3digit
Sample Frequency	400ms
Over range	Display 1 or -1
Operating Temperature	0 to 55 °C
Storage Temperature	-10 to +80 °C
Humidity	20%-80%
Weight	50-55g
Dimension	W79 x H42.5 x D25.5mm
Installation size	76 x 39 mm
Mounting Method	Snap-in

CONNECTION DIAGRAM:

View of PINs with screen facing upwards.

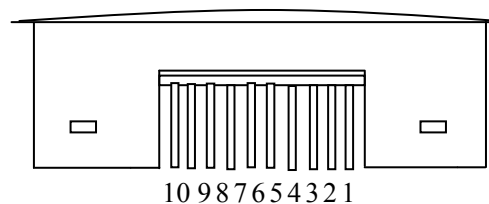

- PIN 1 DC + voltage signal input
- PIN 2 DC - voltage signal input
- PIN 3 200mV /2V range conversion
[Short connection PIN3 & PIN10, measure 1.9999V]
- PIN 4 Decimal position 199.99[Short connection PIN4 & PIN10]
- PIN 5 Decimal position 1999.9[Short connection PIN5 & PIN10]
- PIN 6 Decimal position 19.999[Short connection PIN6 & PIN10]
- PIN 7 Decimal position 1.9999[Short connection PIN7 & PIN10]
- PIN 8 Data Hold [Short connection PIN8 & PIN10]
- PIN 9 DC5V- Power supply
- PIN 10 DC5V+ Power supply

Model	Range	Resolution	Input Impedance	Max Voltage Input	Accuracy
XL41LCD-1	± 199.99mV	10μV	10MΩ	± 35V	±0.05%+3digit
XL41LCD-2	± 1.9999V	100μV	4.5MΩ	± 35V	±0.05%+3digit
XL41LCD-3	± 19.999V	1V	4.5MΩ	± 250V	±0.05%+3digit
XL41LCD-4	± 199.99V	10mV	4.5MΩ	± 500V	±0.05%+3digit

XL41LCD Series DC voltmeter

Power Source DC5V

FEATURES:

- Power supply DC5V
- LCD display with Blue backlighting
- 15.00mm digit height
- Low cost
- High accuracy
- Decimal point is settable by user
- Easy to install, snap-in/mount in panel
- Ideal for auto, boat, industrial, commercial & domestic uses

OPERATION SPECIFICATIONS:

Power Source	DC5V±0.2V (2 mA)
Maximum Count	19999 (4.5 digits)
Accuracy	±0.05%+3digit
Sample Frequency	400ms
Over range	Display 1 or -1
Operating Temperature	0 to 55 °C
Storage Temperature	-10 to +80 °C
Humidity	20%-80%
Weight	50-55g
Dimension	W79 x H42.5 x D25.5mm
Installation size	76 x 39 mm
Mounting Method	Snap-in

CONNECTION DIAGRAM:

View of PINs with screen facing upwards.

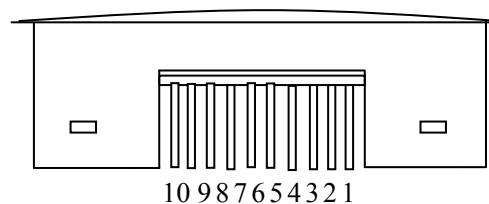

- PIN 1 DC + voltage signal input
- PIN 2 DC - voltage signal input
- PIN 3 200mV /2V range conversion
[Short connection PIN3 & PIN10, measure 1.9999V]
- PIN 4 Decimal position 199.99[Short connection PIN4 & PIN10]
- PIN 5 Decimal position 1999.9[Short connection PIN5 & PIN10]
- PIN 6 Decimal position 19.999[Short connection PIN6 & PIN10]
- PIN 7 Decimal position 1.9999[Short connection PIN7 & PIN10]
- PIN 8 Data Hold [Short connection PIN8 & PIN10]
- PIN 9 DC5V- Power supply
- PIN 10 DC5V+ Power supply

Model	Range	Resolution	Input Impedance	Max Voltage Input	Accuracy
XL41LCD-1	± 199.99mV	10μV	10MΩ	± 35V	±0.05%+3digit
XL41LCD-2	± 1.9999V	100μV	4.5MΩ	± 35V	±0.05%+3digit
XL41LCD-3	± 19.999V	1V	4.5MΩ	± 250V	±0.05%+3digit
XL41LCD-4	± 199.99V	10mV	4.5MΩ	± 500V	±0.05%+3digit