

Basic Troubleshooting

*LED not displayed

Check the power source is correct voltage (AC220V) and correct polarity.

*Display appears scrambled

Check that all connections are correct and tight.
Check that there is no harsh interference nearby.

*Caution

The power dont turn on before all of connection wire was connected. Don't touch connection terminal after the power is turn on.

Keep far away strong electromagnetic disturbance

Do not disassemble

The power polarity is not reversed

*Panel Cutout Size

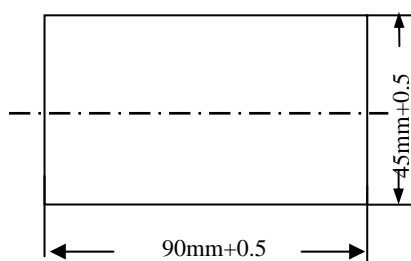

XL2000R

MANUAL

DIGITAL TACHOMETER

XIELI

ISO9001-2008 & CE

Shaanxi XIELI Photo Electric Instrument Co., Ltd

Add: No.2 Xinke Rd, Eastern Development Zone,
Xi'an 710043, Shaanxi, CHINA

Tel: +86-29-82621387 Fax:+86-29-84023638

Email: info@xieli-china.com

http://www.xieli-china.com/a/index_en/index.html

XL2000R

Basic Troubleshooting

*LED not displayed

Check the power source is correct voltage (AC220V) and correct polarity.

*Display appears scrambled

Check that all connections are correct and tight.
Check that there is no harsh interference nearby.

*Caution

The power dont turn on before all of connection wire was connected. Don't touch connection terminal after the power is turn on.

Keep far away strong electromagnetic disturbance

Do not disassemble

The power polarity is not reversed

*Panel Cutout Size

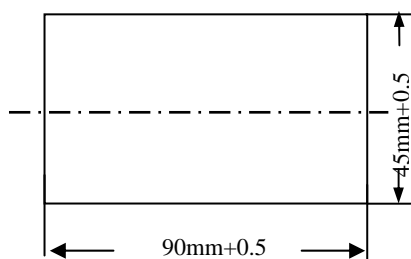

XIELI

ISO9001-2008 & CE

Shaanxi XIELI Photo Electric Instrument Co., Ltd

Add: No.2 Xinke Rd, Eastern Development Zone,
Xi'an 710043, Shaanxi, CHINA

Tel: +86-29-82621387 Fax:+86-29-84023638

Email: info@xieli-china.com

http://www.xieli-china.com/a/index_en/index.html

XL2000R Digital Tachometer

Power Source AC220V measure Max. 9000 RPM

FEATURES:

- Ultra-bright LED display
- Red displays available
- 15.00mm digit height
- High precision, Low cost
- Easy to installation
- Green terminals
- Ideal for auto, boat, industrial & commercial

SPECIFICATIONS:

Model No.	XL2000R
Power Supply	AC220V 30mA
Measure Range	9000RPM
Resolution	30Revolution
Accuracy	0.2%+2 digit
Operating temperature	0°C~55°C
Relative humidity	20%~80%
Net Weight	320~350g
Dimension	W96mm x H48mm x D87.0mm
Panel Cutout Size	90mm×45mm

WIRING DIAGRAM

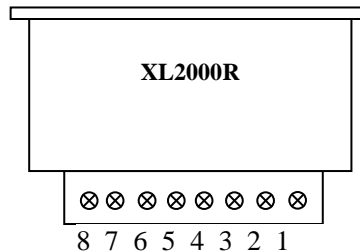

- PIN 1: Proximity Sensor/ Black cable
- PIN 2: Proximity Sensor/ Blue cable
- PIN 3: Proximity Sensor/ Brown cable
- PIN 4~6: Blank
- PIN 7: AC220V N
- PIN 8: AC220V Living

SENSOR: J12-D4NK

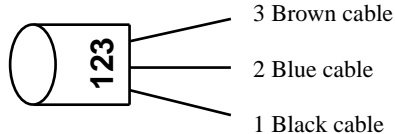

- Terminal 1 connected with Sensor 1 [Black cable]
- Terminal 2 connected with Sensor 2 [Blue cable]
- Terminal 3 connected with Sensor 3 [Brown cable]

XL2000R Digital Tachometer

Power Source AC220V measure Max. 9000 RPM

FEATURES:

- Ultra-bright LED display
- Red displays available
- 15.00mm digit height
- High precision, Low cost
- Easy to installation
- Green terminals
- Ideal for auto, boat, industrial & commercial

SPECIFICATIONS:

Model No.	XL2000R
Power Supply	AC220V 30mA
Measure Range	9000RPM
Resolution	30Revolution
Accuracy	0.2%+2 digit
Operating temperature	0°C~55°C
Relative humidity	20%~80%
Net Weight	320~350g
Dimension	W96mm x H48mm x D87.0mm
Panel Cutout Size	90mm×45mm

WIRING DIAGRAM

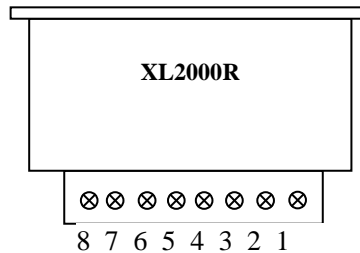

- PIN 1: Proximity Sensor/ Black cable
- PIN 2: Proximity Sensor/ Blue cable
- PIN 3: Proximity Sensor/ Brown cable
- PIN 4~6: Blank
- PIN 7: AC220V N
- PIN 8: AC220V Living

SENSOR: J12-D4NK

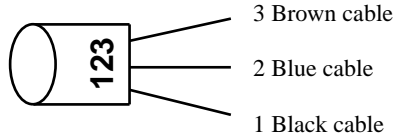

- Terminal 1 connected with Sensor 1 [Black cable]
- Terminal 2 connected with Sensor 2 [Blue cable]
- Terminal 3 connected with Sensor 3 [Brown cable]